



# Dimensions

## Inlet – Provided in inches and millimeters

Dimensions are for reference only

### plug

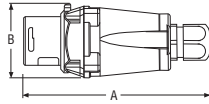

PRODUCT	A	B
	5.00	2.01
DXN20	127	51
	5.04	2.68
DXN30	128	68
	5.87	3.27
DXN60	149	83

### Inlet

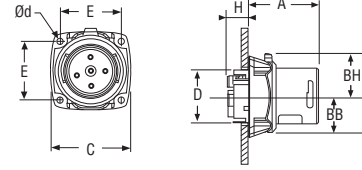

PRODUCT	A	BB	BH	C	D	E	H	Ød
	1.97	0.94	1.06	2.24	1.46	1.65	0.53	0.17
DXN20	50	24	27	57	37	42	13.5	4.2
	1.97	1.26	1.42	2.64	2.28	1.89	0.51	0.18
DXN30	50	32	36	67	58	48	13	4.5
	2.20	1.54	1.73	3.07	2.68	2.17	0.59	0.19
DXN60	56	39	44	78	68	55.2	15	4.8

### 30° inclined inlet/angle with connector on/off

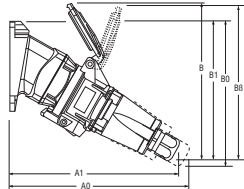

PRODUCT	A1	A0	B	B1	B0	BB
	8.15	8.58	6.61	6.61	6.89	
DXN20	207	218	168	168	175	
	7.99	8.58	8.19	6.02	6.65	
DXN30	203	218	208	153	169	
	9.13	10.16	9.29	7.32	7.91	8.39
DXN60	232	258	236	186	201	213

### 30° inlet/conduit box

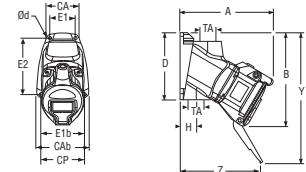

PRODUCT	A	B	CA	CAB	CP	D	E1	E1b	E2	H	PG	Ød
	4.53	4.45	1.77	2.68	2.24	3.54	1.42	2.20	3.07	1.48	0.50	0.18
DXN20	115	113	45	68	57	90	36	56	78	37.5		4.5
	4.41	4.13	3.31	3.31	2.64	4.21	2.76	2.76	2.76	0.69	0.50	0.24
DXN30	112	105	84	84	67	107	70	70	70	17.5		6
	5.20	5.04	3.50		3.07	4.80	3.03	3.46	0.94	0.26		0.26
DXN60	132	128	89		78	122	77	88	24	6.5		6.5

### 30° inclined inlet/conduit box with connector on/off

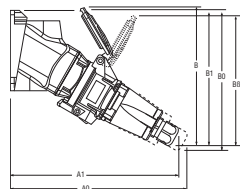

PRODUCT	A1	A0	B	B1	B0	BB
	8.15	8.58	6.61	6.61	6.89	
DXN20	207	218	168	168	175	
	7.99	8.58	8.19	6.02	6.65	
DXN30	203	218	208	153	169	
	9.13	10.16	9.29	7.32	7.91	8.43
DXN60	232	258	236	186	201	214

### 30° inlet/angle

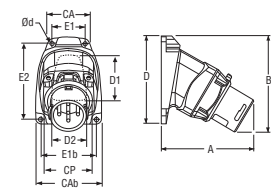

PRODUCT	A	B	CA	CAB	CP	D	D1	D2	E1	E1b	E2	Ød
	3.78	4.02	1.77	2.68	2.24	3.54	2.95	1.97	1.42	2.20	3.07	0.18
DXN20	96	102	45	68	57	90	75	50	36	56	78	4.5
	3.66	4.49	2.99	2.99	2.64	4.21	2.56	3.74	2.48	2.48	3.74	0.22
DXN30	93	114	76	76	67	107	65	95	63	63	95	5.5
	4.06	4.80	2.99	2.99	3.07	4.21	2.56	3.74	2.48	2.48	3.74	0.22
DXN60	103	122	76	76	78	107	65	95	63	63	95	5.5

### 70° inclined inlet/wall box with connector on/off

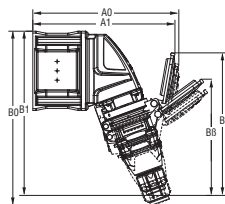

PRODUCT	A1	A0	B	B1	B0	BB
	8.35	8.54	7.68	10.04	10.51	
DXN20	212	217	195	255	267	
	8.50	8.70	8.82	10.12	10.75	
DXN30	216	221	224	257	273	
	9.88	10.28	9.92	12.24	13.43	6.77
DXN60	251	261	252	311	341	172

### 70° inlet/wall box

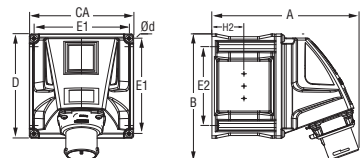

PRODUCT	A	B	CA	D	E1	E2	Ød
	6.77	6.14	5.08	5.08	4.69	3.90	0.17
DXN20	172	156	129	129	119	99	4.2
	6.93	6.26	5.08	5.08	4.69	3.90	0.17
DXN30	176	159	129	129	119	99	4.2
	8.31	7.99	6.81	6.81	6.22	5.47	0.26
DXN60	211	203	173	173	158	139	6.5

# Dimensions

## Receptacle – Provided in inches and millimeters

Dimensions are for reference only

### connector

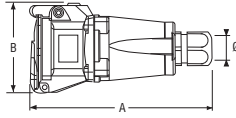

PRODUCT	A	B	Ø
DXN20	5.16	3.07	.32-.59
	131	78	8-15
DXN30	6.38	4.06	.32-.90
	162	103	8-23
DXN60	6.77	4.53	
	172	115	

### receptacle with plug on/off

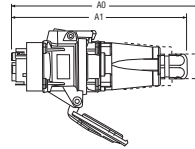

PRODUCT	A1	A0
DXN20	6.14	6.65
	156	169
DXN30	6.65	7.32
	169	186
DXN60	6.89	8.03
	175	204

### receptacle

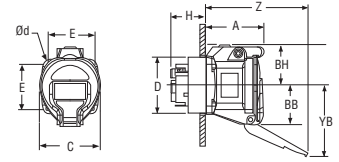

PRODUCT	A	BB	BH	C	D	E	H	YB	Z	Ød
DXN20	2.07	1.57	1.50	2.24	1.99	1.65	0.98	2.76	3.84	0.17
	52.7	40	38	57	50.5	42	25	70	97.5	4.2
DXN30	2.61	2.09	1.97	2.87	2.28	1.89	0.59	3.86	4.47	0.18
	66.2	53	50	73	58	48	15	98	113.6	4.5
DXN60	3.12	2.30	2.20	3.23	2.68	2.17	0.71	4.65	4.76	0.19
	79.2	58.5	56	82	68	55.2	18	118	121	4.8

### 30° inclined receptacle/angle with plug on/off

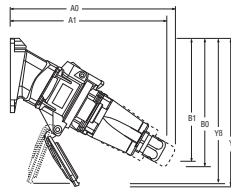

PRODUCT	A1	A0	B1	B0	Y	YB
DXN20	7.40	7.83	6.18	6.46	6.65	
	188	199	157	164	169	
DXN30	7.24	7.83	6.69	7.01	8.23	
	184	199	170	178	209	
DXN60	7.99	9.02	7.09	7.68	9.06	8.15
	203	229	180	195	230	207

### 30° receptacle/angle

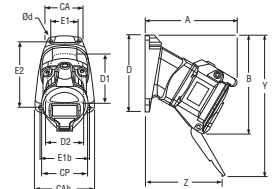

PRODUCT	A	B	CA	CAb	CP	D	D1	D2	E1	E1b	E2	Y	Z	Ød
DXN20	4.25	4.72	1.77	2.68	2.24	3.54	2.95	1.97	1.42	2.20	3.07	6.65	3.62	0.18
	108	120	45	68	57	90	75	50	36	56	78	169	92	4.5
DXN30	4.69	5.55	2.99	2.99	2.87	4.21	2.56	3.74	2.48	2.48	3.74	8.23	3.39	0.22
	119	141	76	76	73	107	65	95	63	63	95	209	86	5.5
DXN60	5.35	6.14	2.99	2.99	3.23	4.21	2.56	3.74	2.48	2.48	3.74	9.06	3.35	0.22
	136	156	76	76	82	107	65	95	63	63	95	230	85	5.5

### 30° inclined receptacle/conduit box with plug on/off

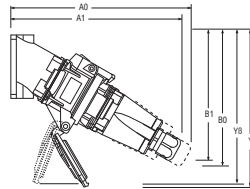

PRODUCT	A1	A0	B1	B0	Y	YB
DXN20	8.15	8.58	6.61	6.89	7.09	
	207	218	168	175	180	
DXN30	7.99	8.58	6.34	6.65	7.87	
	203	218	161	169	200	
DXN60	9.13	10.16	7.32	7.91	9.29	8.15
	232	258	186	201	236	207

### 30° receptacle/conduit box

PRODUCT	A	B	CA	CAb	CP	D	E1	E1b	E2	H	PG	Y	Z	Ød
DXN20	5.00	5.16	1.77	2.68	2.24	3.54	1.42	2.20	3.07	1.48	0.50	7.09	4.37	0.18
	127	131	45	68	57	90	36	56	78	37.5		180	111	4.5
DXN30	5.43	5.20	3.31	3.31	2.87	4.21	2.76	2.76	0.69	0.50	7.87	4.13	0.24	
	138	132	84	84	73	107	70	70	17.5			200	105	6
DXN60	6.50	6.38	3.50		3.23	4.80	3.03		3.46	0.94		9.29	4.49	0.26
	165	162	89		82	122	77		88	24		236	114	6.5

### 70° inclined receptacle/wall box with plug on/off

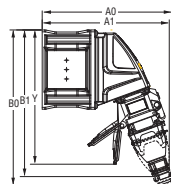

PRODUCT	A1	A0	B1	B0	Y	YB
DXN20	8.35	8.54	10.04	10.51	8.58	
	212	217	255	267	218	
DXN30	8.50	8.70	10.12	10.75	9.61	
	216	221	257	273	244	
DXN60	9.88	10.28	12.24	13.35	11.57	8.39
	251	261	311	339	294	213

### 70° receptacle/wall box

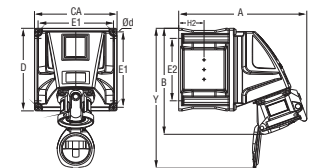

PRODUCT	A	B	CA	D	E1	E2	Ød
DXN20	7.52	6.42	5.08	5.08	4.69	3.90	0.17
	191	163	129	129	119	99	4.2
DXN30	8.03	6.85	5.08	5.08	4.69	3.90	0.17
	204	174	129	129	119	99	4.2
DXN60	9.57	9.09	6.81	6.81	6.22	5.47	0.26
	243	231	173	173	158	139	6.5